

EUROPEAN PATENT OFFICE
U.S. PATENT AND TRADEMARK OFFICE

CPC NOTICE OF CHANGES 1261

DATE: FEBRUARY 1, 2022

PROJECT RP0552

The following classification changes will be effected by this Notice of Changes :

<u>Action</u>	<u>Subclass</u>	<u>Group(s)</u>
SCHEME:		
Symbols Deleted:	B23C	5/207, 5/2217, 5/2221, 5/223, 5/2256, 5/2282, 5/2286, 5/2403, 5/2406, 5/241, 5/2413, 5/2417, 5/242, 5/2424, 5/2427, 5/2431, 5/2434, 5/2437, 5/2441, 5/2444, 5/2448, 5/2451, 5/2455, 5/2458
	B23C	2200/087
Symbols Deleted Pending Reclassification: (frozen (F))	B23C	2200/283, 2200/286
Symbols New:	B23C	5/2298, 5/2301, 5/2304, 5/2306, 5/2309, 5/281, 5/282, 5/283, 5/285, 5/286, 5/287
	B23C	2200/281, 2200/284, 2200/287, 2200/289, 2200/291, 2200/293, 2200/364, 2200/369, 2200/3691
	B23C	2210/501, 2210/502, 2210/504, 2210/641
Titles Changed:	B23C	5/1081, 5/202, 5/205, 5/2204, 5/2208, 5/2213, 5/2226, 5/2243, 5/2252, 5/2269, 5/2278, 5/2486
	B23C	2200/326, 2200/363
Warnings New:	B23C	5/202, 5/205, 5/22, 5/2204, 5/2208, 5/2213, 5/2226, 5/2234, 5/2239, 5/2243, 5/2247, 5/2252, 5/226, 5/2265, 5/2269, 5/2273, 5/2278, 5/2291, 5/2295, 5/2298, 5/2301, 5/2304, 5/2306, 5/2309, 5/24, 5/2462, 5/2465, 5/2468, 5/2472, 5/2475, 5/2479, 5/2482, 5/2486, 5/2489, 5/2493, 5/2496, 5/28, 5/281, 5/282, 5/283, 5/285, 5/286
	B23C	2200/28, 2200/281, 2200/283, 2200/284, 2200/286, 2200/287, 2200/289, 2200/291, 2200/293, 2200/36, 2200/364, 2200/369
	B23C	2210/50, 2210/501, 2210/502, 2210/504, 2210/64, 2210/641
DEFINITIONS:		

CPC NOTICE OF CHANGES 1261

DATE: FEBRUARY 1, 2022

PROJECT RP0552

<u>Action</u>	<u>Subclass</u>	<u>Group(s)</u>
Definitions New:	B23C	5/04, 5/06, 5/08, 5/10, 5/1036, 5/1054, 5/1081, 5/109, 5/12, 5/18, 5/20, 5/202, 5/205, 5/22, 5/2208, 5/2213, 5/2226, 5/2234, 5/2239, 5/2243, 5/2247, 5/2252, 5/2269, 5/2291, 5/2295, 5/2309, 5/24, 5/2462, 5/2465, 5/2468, 5/2472, 5/2475, 5/2479, 5/2482, 5/2486, 5/26, 5/28, 5/281, 5/282, 5/283, 5/285, 5/286, 5/287
Definitions Modified:	B23C	5/00

No other subclasses/groups are impacted by this Notice of Changes.

This Notice of Changes includes the following [Check the ones included]:

1. CLASSIFICATION SCHEME CHANGES

- A. New, Modified or Deleted Group(s)
- B. New, Modified or Deleted Warning(s)
- C. New, Modified or Deleted Note(s)
- D. New, Modified or Deleted Guidance Heading(s)

2. DEFINITIONS

- A. New or Modified Definitions (Full definition template)
- B. Modified or Deleted Definitions (Definitions Quick Fix)

3. REVISION CONCORDANCE LIST (RCL)

4. CHANGES TO THE CPC-TO-IPC CONCORDANCE LIST (CICL)

5. CHANGES TO THE CROSS-REFERENCE LIST (CRL)

CPC NOTICE OF CHANGES 1261

DATE: FEBRUARY 1, 2022

PROJECT RP0552

1. CLASSIFICATION SCHEME CHANGES

A. New, Modified or Deleted Group(s)

SUBCLASS B23C - MILLING

<u>Type*</u>	<u>Symbol</u>	<u>Indent Level Number of dots (e.g. 0, 1, 2)</u>	<u>Title (new or modified)</u> <u>“CPC only” text should normally be enclosed in {curly brackets}**</u>	<u>Transferred to#</u>
M	B23C 5/1081	3	{with permanently fixed cutting inserts (B23C 5/1018 and B23C 5/1063 take precedence)}	
C	B23C 5/202	3	{Plate-like cutting inserts with special form (special form related to securing of the insert B23C 5/22)}	B23C 5/202, B23C 5/205
T	B23C 5/205	4	{characterised by chip-breakers of special form}	
D	B23C 5/207	4	{having a special shape}	<Administrative transfer to B23C 5/202>
C	B23C 5/22	3	Securing arrangements for bits or teeth {or cutting inserts }	B23C 5/22, B23C 5/2298, B23C 5/2301, B23C 5/2304, B23C 5/2306, B23C 5/2309
C	B23C 5/2204	4	{with cutting inserts clamped against the walls of the recess in the cutter body by a clamping member acting upon the wall of a hole in the insert }	B23C 5/2204, B23C 5/2298
C	B23C 5/2208	5	{for plate-like cutting inserts (B23C 5/2226, B23C 5/2234 take precedence)}	B23C 5/2208, B23C 5/2301
C	B23C 5/2213	6	{having a special shape}	B23C 5/2213, B23C 5/2304
D	B23C 5/2217	7	{having chip-breakers}	<Administrative transfer to B23C 5/205>
D	B23C 5/2221	7	{having a special shape}	<Administrative transfer to B23C 5/2213>
C	B23C 5/2226	5	{for plate-like cutting inserts fitted on an intermediate carrier, e.g. shank fixed in the cutter body }	B23C 5/2226, B23C 5/2306
D	B23C 5/223	5	{for plate-like cutting inserts fitted on a shank, fixed in the cutter body }	<Administrative transfer to B23C 5/2226>
C	B23C 5/2234	5	{for plate-like cutting inserts fitted on a ring or ring segment }	B23C 5/2234, B23C 5/2309
C	B23C 5/2239	4	{with cutting inserts clamped by a clamping member acting almost perpendicular on the cutting face }	B23C 5/2239, B23C 5/2298
C	B23C 5/2243	5	{for plate-like cutting inserts (B23C 5/2252, B23C 5/226 take precedence)}	B23C 5/2243, B23C 5/2301

CPC NOTICE OF CHANGES 1261

DATE: FEBRUARY 1, 2022

PROJECT RP0552

<u>Type*</u>	<u>Symbol</u>	<u>Indent Level</u> <u>Number of dots</u> <u>(e.g. 0, 1, 2)</u>	<u>Title</u> <u>(new or modified)</u> <u>“CPC only” text should normally be enclosed in</u> <u>{curly brackets}**</u>	<u>Transferred to#</u>
C	B23C 5/2247	6	{having a special shape}	B23C 5/2247, B23C 5/2304
C	B23C 5/2252	5	{for plate-like cutting inserts fitted on an intermediate carrier, e.g. shank fixed in the cutter body}	B23C 5/2252, B23C 5/2306
D	B23C 5/2256	5	{for plate-like cutting inserts fitted on a shank, fixed in the cutter body}	<Administrative transfer to B23C 5/2252>
C	B23C 5/226	5	{for plate-like cutting inserts fitted on a ring or ring segment}	B23C 5/226, B23C 5/2309
C	B23C 5/2265	4	{by means of a wedge}	B23C 5/2265, B23C 5/2298
C	B23C 5/2269	5	{for plate-like cutting inserts (B23C 5/2278, B23C 5/2291 take precedence)}	B23C 5/2269, B23C 5/2301
C	B23C 5/2273	6	{having a special shape}	B23C 5/2273, B23C 5/2304
C	B23C 5/2278	5	{for plate-like cutting inserts fitted on an intermediate carrier, e.g. shank fixed in the cutter body}	B23C 5/2278, B23C 5/2306
D	B23C 5/2282	6	{having a special shape}	<Administrative transfer to B23C 5/2278>
D	B23C 5/2286	5	{for plate-like cutting inserts fitted on a shank, fixed in the cutter body}	<Administrative transfer to B23C 5/2278>
C	B23C 5/2291	5	{for plate-like cutting inserts fitted on a ring or ring segment}	B23C 5/2291, B23C 5/2309
C	B23C 5/2295	4	{the cutting elements being clamped simultaneously}	B23C 5/2295, B23C 5/2298
N	B23C 5/2298	4	{secured by resilient/flexible means}	
N	B23C 5/2301	5	{for plate-like cutting inserts (B23C 5/2306, B23C 5/2309 take precedence)}	
N	B23C 5/2304	6	{having a special shape}	
N	B23C 5/2306	5	{for plate-like cutting inserts fitted on an intermediate carrier, e.g. shank fixed in the cutter body}	
N	B23C 5/2309	5	{for plate-like cutting inserts fitted on a ring or ring segment}	
C	B23C 5/24	4	adjustable	B23C 5/24, B23C 5/2462, B23C 5/2465, B23C 5/2468, B23C 5/2472, B23C 5/2475, B23C 5/2479, B23C 5/2482, B23C 5/2486, B23C 5/2489, B23C 5/2493, B23C 5/2496

CPC NOTICE OF CHANGES 1261

DATE: FEBRUARY 1, 2022

PROJECT RP0552

<u>Type*</u>	<u>Symbol</u>	<u>Indent Level Number of dots (e.g. 0, 1, 2)</u>	<u>Title (new or modified)</u> <u>“CPC only” text should normally be enclosed in curly brackets**</u>	<u>Transferred to#</u>
D	B23C 5/2403	5	{with cutting inserts clamped against the walls of the recess in the shank by a clamping member acting upon the wall of a hole in the insert}	<Administrative transfer to B23C 5/24 and B23C 5/2204 simultaneously>
D	B23C 5/2406	6	{for plate-like cutting inserts (B23C 5/241, B23C 5/2413, B23C 5/2417 take precedence)}	<Administrative transfer to B23C 5/24 and B23C 5/2208 simultaneously>
D	B23C 5/241	6	{for plate-like cutting inserts fitted on an intermediate carrier}	<Administrative transfer to B23C 5/24 and B23C 5/2226 simultaneously>
D	B23C 5/2413	6	{for plate-like cutting inserts fitted on a shank, fixed in the cutter body}	<Administrative transfer to B23C 5/24 and B23C 5/2226 simultaneously>
D	B23C 5/2417	6	{for plate-like cutting inserts fitted on a ring or ring segment}	<Administrative transfer to B23C 5/24 and B23C 5/2234 simultaneously>
D	B23C 5/242	5	{with cutting inserts clamped by a clamping member acting almost perpendicularly on the cutting face}	<Administrative transfer to B23C 5/24 and B23C 5/2239 simultaneously>
D	B23C 5/2424	6	{for plate-like cutting inserts (B23C 5/2427, B23C 5/2431, B23C 5/2434 take precedence)}	<Administrative transfer to B23C 5/24 and B23C 5/2243 simultaneously>
D	B23C 5/2427	6	{for plate-like cutting inserts fitted on an intermediate carrier}	<Administrative transfer to B23C 5/24 and B23C 5/2252 simultaneously>
D	B23C 5/2431	6	{for plate-like cutting inserts fitted on a shank, fixed in the cutter body}	<Administrative transfer to B23C 5/24 and B23C 5/2252 simultaneously>
D	B23C 5/2434	6	{for plate-like cutting inserts fitted on a ring or ring segment}	<Administrative transfer to B23C 5/24 and B23C 5/226 simultaneously>
D	B23C 5/2437	5	{clamping by means of a wedge}	<Administrative transfer to B23C 5/24 and B23C 5/2265 simultaneously>
D	B23C 5/2441	6	{for plate-like cutting inserts (B23C 5/2444, B23C 5/2448, B23C 5/2451 take precedence)}	<Administrative transfer to B23C 5/24 and B23C 5/2269 simultaneously>
D	B23C 5/2444	6	{for plate-like cutting inserts fitted on an intermediate carrier}	<Administrative transfer to B23C 5/24 and B23C 5/2278 simultaneously>
D	B23C 5/2448	6	{for plate-like cutting inserts fitted on a shank, fixed in the cutter body}	<Administrative transfer to B23C 5/24 and B23C 5/2278 simultaneously>
D	B23C 5/2451	6	{for plate-like cutting inserts fitted on a ring or ring segment}	<Administrative transfer to B23C 5/24 and B23C 5/2291 simultaneously>

CPC NOTICE OF CHANGES 1261

DATE: FEBRUARY 1, 2022

PROJECT RP0552

Type*	Symbol	Indent Level Number of dots (e.g. 0, 1, 2)	Title (new or modified) "CPC only" text should normally be enclosed in {curly brackets}**	Transferred to#
D	B23C 5/2455	6	{The adjusting means being serrated teeth on the cutter and the cutting insert }	<Administrative transfer to B23C 5/24 and B23C 5/2265 simultaneously>
D	B23C 5/2458	5	{the cutting elements being clamped or adjusted simultaneously }	<Administrative transfer to B23C 5/24 and B23C 5/2295 simultaneously>
T	B23C 5/2486	5	{where the adjustment is made by elastically deforming the toolholders }	
C	B23C 5/28	1	Features relating to lubricating or cooling	B23C 5/28, B23C 5/281, B23C 5/282, B23C 5/283, B23C 5/285, B23C 5/286, B23C 5/287
N	B23C 5/281	2	{Coolant moving along the outside tool periphery towards the cutting edges }	
N	B23C 5/282	2	{Coolant channel characterised by its cross-sectional shape }	
N	B23C 5/283	2	{Cutting inserts with internal coolant channels }	
N	B23C 5/285	2	{Nozzles }	
N	B23C 5/286	2	{Deflectors }	
N	B23C 5/287	3	{intersecting the rotational axis }	
D	B23C 2200/087	3	for chip-breaking (with chip-breaking grooves in general B23C 2200/326)	<Administrative transfer to B23C 2200/326>
C	B23C 2200/28	1	Angles	B23C 2200/28, B23C 2200/291, B23C 2200/293
N	B23C 2200/281	2	Negative rake angles	
F	B23C 2200/283	2	Negative cutting angles	B23C 2200/281, B23C 2200/284
N	B23C 2200/284	2	Negative clearance angles	
F	B23C 2200/286	2	Positive cutting angles	B23C 2200/287, B23C 2200/289
N	B23C 2200/287	2	Positive rake angles	
N	B23C 2200/289	2	Positive clearance angles	
N	B23C 2200/291	2	Variable rake angles	
N	B23C 2200/293	2	Variable clearance angles	
T	B23C 2200/326	2	by chip-breaking grooves	
C	B23C 2200/36	1	Other features of the milling insert not covered by B23C 2200/04 - B23C 2200/32	B23C 2200/36, B23C 2200/364, B23C

CPC NOTICE OF CHANGES 1261

DATE: FEBRUARY 1, 2022

PROJECT RP0552

<u>Type*</u>	<u>Symbol</u>	<u>Indent Level Number of dots (e.g. 0, 1, 2)</u>	<u>Title (new or modified)</u> <u>“CPC only” text should normally be enclosed in {curly brackets}**</u>	<u>Transferred to#</u>
				2200/369, B23C 2200/3691
M	B23C 2200/363	2	Lines for indexing round inserts	
N	B23C 2200/364	2	Porous inserts, e.g. lattice-shaped constructions	
U	B23C 2200/368	2	Roughened surfaces	
N	B23C 2200/369	2	Double-sided inserts	
N	B23C 2200/3691	3	Split inserts	
C	B23C 2210/50	1	Cutting inserts	B23C 2210/50, B23C 2210/501, B23C 2210/502, B23C 2210/504
N	B23C 2210/501	2	with cutting edges following one or more helices	
N	B23C 2210/502	2	with cutting edges following straight flutes or rows of more than one insert	
U	B23C 2210/503	2	mounted internally on the cutter	
N	B23C 2210/504	2	arranged in a manner that only extends longitudinally by one insert	
C	B23C 2210/64	1	End milling cutters having a groove in the end cutting face, the groove not being present so as to provide a cutting edge	B23C 2210/64, B23C 2210/641
N	B23C 2210/641	2	at least one groove or gash being different than another	

*N = new entries where reclassification into entries is involved; C = entries with modified file scope where reclassification of documents from the entries is involved; Q = new entries which are firstly populated with documents via administrative transfers from deleted (D) entries. Afterwards, the transferred documents into the Q entry will either stay or be moved to more appropriate entries, as determined by intellectual reclassification; T = existing entries with enlarged file scope, which receive documents from C or D entries, e.g. when a limiting reference is removed from the entry title; M = entries with no change to the file scope (no reclassification); D = deleted entries; F = frozen entries will be deleted once reclassification of documents from the entries is completed; U = entries that are unchanged.

NOTES:

- **No {curly brackets} are used for titles in CPC only subclasses, e.g. C12Y, A23Y; 2000 series symbol titles of groups found at the end of schemes (orthogonal codes); or the Y section titles. The {curly brackets} are used for 2000 series symbol titles found interspersed throughout the main trunk schemes (breakdown codes).
- U groups: it is obligatory to display the required “anchor” symbol (U group), i.e. the entry immediately preceding a new group or an array of new groups to be created (in case new groups are not clearly subgroups of C-type groups). Always include the symbol, indent level and title of the U group in the table above.
- All entry types should be included in the scheme changes table above for better understanding of the overall scheme change picture. Symbol, indent level, and title are required for all types.
- “Transferred to” column must be completed for all C, D, F, and Q type entries. F groups will be deleted once reclassification is completed.

CPC NOTICE OF CHANGES 1261

DATE: FEBRUARY 1, 2022

PROJECT RP0552

- When multiple symbols are included in the “Transferred to” column, avoid using ranges of symbols in order to be as precise as possible.
- For administrative transfer of documents, the following text should be used: “< administrative transfer to XX>”, “<administrative transfer to XX and YY simultaneously>”, or “<administrative transfer to XX, YY, ...and ZZ simultaneously>” when administrative transfer of the same documents is to more than one place.
- Administrative transfer to main trunk groups is assumed to be the source allocation type, unless otherwise indicated.
- Administrative transfer to 2000/Y series groups is assumed to be “additional information”.
- If needed, instructions for allocation type should be indicated within the angle brackets using the abbreviations “ADD” or “INV”: <administrative transfer to XX ADD> , <administrative transfer to XX INV>, or < administrative transfer to XX ADD, YY INV, ... and ZZ ADD simultaneously>.
- In certain situations, the “D” entries of 2000-series or Y-series groups may not require a destination (“Transferred to”) symbol, however it is required to specify “<no transfer>” in the “Transferred to” column for such cases.
- For finalisation projects, the deleted “F” symbols should have <no transfer> in the “Transferred to” column.
- For more details about the types of scheme change, see CPC Guide.

CPC NOTICE OF CHANGES 1261

DATE: FEBRUARY 1, 2022

PROJECT RP0552

B. New, Modified or Deleted Warning(s)

SUBCLASS B23C - MILLING

<u>Type*</u>	<u>Location</u>	<u>Old Warning</u>	<u>New/Modified Warning</u>
N	B23C 5/202		Group B23C 5/202 is impacted by reclassification into group B23C 5/205. Groups B23C 5/202 and B23C 5/205 should be considered in order to perform a complete search.
N	B23C 5/205		Group B23C 5/205 is incomplete pending reclassification of documents from group B23C 5/202. Groups B23C 5/202 and B23C 5/205 should be considered in order to perform a complete search.
N	B23C 5/22		Group B23C 5/22 is impacted by reclassification into groups B23C 5/2298, B23C 5/2301, B23C 5/2304, B23C 5/2306 and B23C 5/2309. All groups listed in this Warning should be considered in order to perform a complete search.
N	B23C 5/2204		Group B23C 5/2204 is impacted by reclassification into group B23C 5/2298. Groups B23C 5/2204 and B23C 5/2298 should be considered in order to perform a complete search.
N	B23C 5/2208		Group B23C 5/2208 is impacted by reclassification into group B23C 5/2301. Groups B23C 5/2208 and B23C 5/2301 should be considered in order to perform a complete search.
N	B23C 5/2213		Group B23C 5/2213 is impacted by reclassification into group B23C 5/2304. Groups B23C 5/2213 and B23C 5/2304 should be considered in order to perform a complete search.
N	B23C 5/2226		Group B23C 5/2226 is impacted by reclassification into group B23C 5/2306. Groups B23C 5/2226 and B23C 5/2306 should be considered in order to perform a complete search.
N	B23C 5/2234		Group B23C 5/2234 is impacted by reclassification into group B23C 5/2309. Groups B23C 5/2234 and B23C 5/2309 should be

CPC NOTICE OF CHANGES 1261

DATE: FEBRUARY 1, 2022

PROJECT RP0552

<u>Type*</u>	<u>Location</u>	<u>Old Warning</u>	<u>New/Modified Warning</u>
			considered in order to perform a complete search.
N	B23C 5/2239		Group B23C 5/2239 is impacted by reclassification into group B23C 5/2298. Groups B23C 5/2239 and B23C 5/2298 should be considered in order to perform a complete search.
N	B23C 5/2243		Group B23C 5/2243 is impacted by reclassification into group B23C 5/2301. Groups B23C 5/2243 and B23C 5/2301 should be considered in order to perform a complete search.
N	B23C 5/2247		Group B23C 5/2247 is impacted by reclassification into group B23C 5/2304. Groups B23C 5/2247 and B23C 5/2304 should be considered in order to perform a complete search.
N	B23C 5/2252		Group B23C 5/2252 is impacted by reclassification into group B23C 5/2306. Groups B23C 5/2252 and B23C 5/2306 should be considered in order to perform a complete search.
N	B23C 5/226		Group B23C 5/226 is impacted by reclassification into group B23C 5/2309. Groups B23C 5/226 and B23C 5/2309 should be considered in order to perform a complete search.
N	B23C 5/2265		Group B23C 5/2265 is impacted by reclassification into group B23C 5/2298. Groups B23C 5/2265 and B23C 5/2298 should be considered in order to perform a complete search.
N	B23C 5/2269		Group B23C 5/2269 is impacted by reclassification into group B23C 5/2301. Groups B23C 5/2269 and B23C 5/2301 should be considered in order to perform a complete search.
N	B23C 5/2273		Group B23C 5/2273 is impacted by reclassification into group B23C 5/2304. Groups B23C 5/2273 and B23C 5/2304 should be considered in order to perform a complete search.
N	B23C 5/2278		Group B23C 5/2278 is impacted by reclassification into group

CPC NOTICE OF CHANGES 1261

DATE: FEBRUARY 1, 2022

PROJECT RP0552

<u>Type*</u>	<u>Location</u>	<u>Old Warning</u>	<u>New/Modified Warning</u>
			B23C 5/2306. Groups B23C 5/2278 and B23C 5/2306 should be considered in order to perform a complete search.
N	B23C 5/2291		Group B23C 5/2291 is impacted by reclassification into group B23C 5/2309. Groups B23C 5/2291 and B23C 5/2309 should be considered in order to perform a complete search.
N	B23C 5/2295		Group B23C 5/2295 is impacted by reclassification into group B23C 5/2298. Groups B23C 5/2295 and B23C 5/2298 should be considered in order to perform a complete search.
N	B23C 5/2298		Group B23C 5/2298 is incomplete pending reclassification of documents from groups B23C 5/22, B23C 5/2204, B23C 5/2239, B23C 5/2265 and B23C 5/2295. All groups listed in this Warning should be considered in order to perform a complete search.
N	B23C 5/2301		Group B23C 5/2301 is incomplete pending reclassification of documents from groups B23C 5/22, B23C 5/2208, B23C 5/2243 and B23C 5/2269. All groups listed in this Warning should be considered in order to perform a complete search.
N	B23C 5/2304		Group B23C 5/2304 is incomplete pending reclassification of documents from groups B23C 5/22, B23C 5/2213, B23C 5/2247 and B23C 5/2273. All groups listed in this Warning should be considered in order to perform a complete search.
N	B23C 5/2306		Group B23C 5/2306 is incomplete pending reclassification of documents from groups B23C 5/22, B23C 5/2226, B23C 5/2252 and B23C 5/2278. All groups listed in this Warning should be considered in order to perform a complete search.
N	B23C 5/2309		Group B23C 5/2309 is incomplete pending reclassification of documents from groups B23C 5/22, B23C 5/2234, B23C 5/226 and B23C 5/2291. All groups listed in this Warning should be considered in order to perform a complete search.

CPC NOTICE OF CHANGES 1261

DATE: FEBRUARY 1, 2022

PROJECT RP0552

<u>Type*</u>	<u>Location</u>	<u>Old Warning</u>	<u>New/Modified Warning</u>
N	B23C 5/24		Group B23C 5/24 is impacted by reclassification into groups B23C 5/2462, B23C 5/2465, B23C 5/2468, B23C 5/2472, B23C 5/2475, B23C 5/2479, B23C 5/2482, B23C 5/2486, B23C 5/2489, B23C 5/2493 and B23C 5/2496. All groups listed in this Warning should be considered in order to perform a complete search.
N	B23C 5/2462		Group B23C 5/2462 is incomplete pending reclassification of documents from group B23C 5/24. Groups B23C 5/24 and B23C 5/2462 should be considered in order to perform a complete search.
N	B23C 5/2465		Group B23C 5/2465 is incomplete pending reclassification of documents from group B23C 5/24. Groups B23C 5/24 and B23C 5/2465 should be considered in order to perform a complete search.
N	B23C 5/2468		Group B23C 5/2468 is incomplete pending reclassification of documents from group B23C 5/24. Groups B23C 5/24 and B23C 5/2468 should be considered in order to perform a complete search.
N	B23C 5/2472		Group B23C 5/2472 is incomplete pending reclassification of documents from group B23C 5/24. Groups B23C 5/24 and B23C 5/2472 should be considered in order to perform a complete search.
N	B23C 5/2475		Group B23C 5/2475 is incomplete pending reclassification of documents from group B23C 5/24. Groups B23C 5/24 and B23C 5/2475 should be considered in order to perform a complete search.
N	B23C 5/2479		Group B23C 5/2479 is incomplete pending reclassification of documents from group B23C 5/24. Groups B23C 5/24 and B23C 5/2479 should be considered in order to perform a complete search.
N	B23C 5/2482		Group B23C 5/2482 is incomplete pending reclassification of documents from group B23C 5/24. Groups B23C 5/24 and B23C 5/2482 should be considered in order to perform a complete search.

CPC NOTICE OF CHANGES 1261

DATE: FEBRUARY 1, 2022

PROJECT RP0552

<u>Type*</u>	<u>Location</u>	<u>Old Warning</u>	<u>New/Modified Warning</u>
N	B23C 5/2486		Group B23C 5/2486 is incomplete pending reclassification of documents from group B23C 5/24. Groups B23C 5/24 and B23C 5/2486 should be considered in order to perform a complete search.
N	B23C 5/2489		Group B23C 5/2489 is incomplete pending reclassification of documents from group B23C 5/24. Groups B23C 5/24 and B23C 5/2489 should be considered in order to perform a complete search.
N	B23C 5/2493		Group B23C 5/2493 is incomplete pending reclassification of documents from group B23C 5/24. Groups B23C 5/24 and B23C 5/2493 should be considered in order to perform a complete search.
N	B23C 5/2496		Group B23C 5/2496 is incomplete pending reclassification of documents from group B23C 5/24. Groups B23C 5/24 and B23C 5/2496 should be considered in order to perform a complete search.
N	B23C 5/28		Group B23C 5/28 is impacted by reclassification into groups B23C 5/281, B23C 5/282, B23C 5/283, B23C 5/285, B23C 5/286 and B23C 5/287. All groups listed in this Warning should be considered in order to perform a complete search.
N	B23C 5/281		Group B23C 5/281 is incomplete pending reclassification of documents from group B23C 5/28. Groups B23C 5/28 and B23C 5/281 should be considered in order to perform a complete search.
N	B23C 5/282		Group B23C 5/282 is incomplete pending reclassification of documents from group B23C 5/28. Groups B23C 5/28 and B23C 5/282 should be considered in order to perform a complete search.
N	B23C 5/283		Group B23C 5/283 is incomplete pending reclassification of documents from group B23C 5/28. Groups B23C 5/28 and B23C 5/283 should be considered in order to perform a complete search.
N	B23C 5/285		Group B23C 5/285 is incomplete pending reclassification of

CPC NOTICE OF CHANGES 1261

DATE: FEBRUARY 1, 2022

PROJECT RP0552

<u>Type*</u>	<u>Location</u>	<u>Old Warning</u>	<u>New/Modified Warning</u>
			documents from group B23C 5/28. Groups B23C 5/28 and B23C 5/285 should be considered in order to perform a complete search.
N	B23C 5/286		Groups B23C 5/286 and B23C 5/287 are incomplete pending reclassification of documents from group B23C 5/28. Groups B23C 5/28, B23C 5/286 and B23C 5/287 should be considered in order to perform a complete search.
N	B23C 2200/28		Group B23C 2200/28 is impacted by reclassification into groups B23C 2200/291 and B23C 2200/293. Groups B23C 2200/28, B23C 2200/291 and B23C 2200/293 should be considered in order to perform a complete search.
N	B23C 2200/281		Group B23C 2200/281 is incomplete pending reclassification of documents from group B23C 2200/283. Groups B23C 2200/283 and B23C 2200/281 should be considered in order to perform a complete search.
N	B23C 2200/283		Group B23C 2200/283 is no longer used for the classification of documents as of February 1, 2022. The content of this group is being reclassified into groups B23C 2200/281 and B23C 2200/284. Groups B23C 2200/283, B23C 2200/281 and B23C 2200/284 should be considered in order to perform a complete search.
N	B23C 2200/284		Group B23C 2200/284 is incomplete pending reclassification of documents from group B23C 2200/283. Groups B23C 2200/283 and B23C 2200/284 should be considered in order to perform a complete search.
N	B23C 2200/286		Group B23C 2200/286 is no longer used for the classification of documents as of February 1, 2022. The content of this group is being reclassified into groups B23C 2200/287 and B23C 2200/289. Groups B23C 2200/286, B23C 2200/287 and B23C 2200/289 should be considered in order to perform a complete search.

CPC NOTICE OF CHANGES 1261

DATE: FEBRUARY 1, 2022

PROJECT RP0552

<u>Type*</u>	<u>Location</u>	<u>Old Warning</u>	<u>New/Modified Warning</u>
N	B23C 2200/287		Group B23C 2200/287 is incomplete pending reclassification of documents from group B23C 2200/286. Groups B23C 2200/286 and B23C 2200/287 should be considered in order to perform a complete search.
N	B23C 2200/289		Group B23C 2200/289 is incomplete pending reclassification of documents from group B23C 2200/286. Groups B23C 2200/286 and B23C 2200/289 should be considered in order to perform a complete search.
N	B23C 2200/291		Group B23C 2200/291 is incomplete pending reclassification of documents from group B23C 2200/28. Groups B23C 2200/28 and B23C 2200/291 should be considered in order to perform a complete search.
N	B23C 2200/293		Group B23C 2200/293 is incomplete pending reclassification of documents from group B23C 2200/28. Groups B23C 2200/28 and B23C 2200/293 should be considered in order to perform a complete search.
N	B23C 2200/36		Group B23C 2200/36 is impacted by reclassification into groups B23C 2200/364, B23C 2200/369 and B23C 2200/3691. All groups listed in this Warning should be considered in order to perform a complete search.
N	B23C 2200/364		Group B23C 2200/364 is incomplete pending reclassification of documents from group B23C 2200/36. Groups B23C 2200/36 and B23C 2200/364 should be considered in order to perform a complete search.
N	B23C 2200/369		Groups B23C 2200/369 and B23C 2200/3691 are incomplete pending reclassification of documents from group B23C 2200/36. Groups B23C 2200/36, B23C 2200/369 and B23C 2200/3691 should be considered in order to perform a complete search.
N	B23C 2210/50		Group B23C 2210/50 is impacted by reclassification into groups

CPC NOTICE OF CHANGES 1261

DATE: FEBRUARY 1, 2022

PROJECT RP0552

<u>Type*</u>	<u>Location</u>	<u>Old Warning</u>	<u>New/Modified Warning</u>
			B23C 2210/501, B23C 2210/502 and B23C 2210/504. All groups listed in this Warning should be considered in order to perform a complete search.
N	B23C 2210/501		Group B23C 2210/501 is incomplete pending reclassification of documents from group B23C 2210/50. Groups B23C 2210/50 and B23C 2210/501 should be considered in order to perform a complete search.
N	B23C 2210/502		Group B23C 2210/502 is incomplete pending reclassification of documents from group B23C 2210/50. Groups B23C 2210/50 and B23C 2210/502 should be considered in order to perform a complete search.
N	B23C 2210/504		Group B23C 2210/504 is incomplete pending reclassification of documents from group B23C 2210/50. Groups B23C 2210/50 and B23C 2210/504 should be considered in order to perform a complete search.
N	B23C 2210/64		Group B23C 2210/64 is impacted by reclassification into group B23C 2210/641. Groups B23C 2210/64 and B23C 2210/641 should be considered in order to perform a complete search.
N	B23C 2210/641		Group B23C 2210/641 is incomplete pending reclassification of documents from group B23C 2210/64. Groups B23C 2210/64 and B23C 2210/641 should be considered in order to perform a complete search.

*N = new warning, M = modified warning, D = deleted warning

NOTE: The "Location" column only requires the symbol PRIOR to the location of the warning. No further directions such as "before" or "after" are required.

2. A. DEFINITIONS (new)

B23C 5/04

Definition statement

This place covers:

Plain cutters having a generally long (in relation to diameter) circumferential cutting surface. Generally no cutting on end surfaces.

Plain milling cutter:

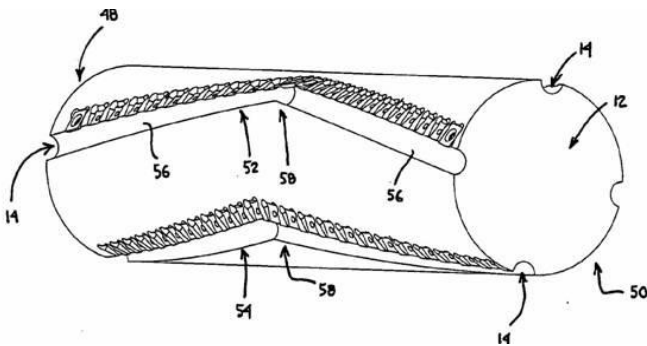

References

Limiting references

This place does not cover:

Shank-type cutters, i.e. with an integral shaft

B23C5/10

B23C 5/06

Definition statement

This place covers:

Face-milling cutters used for producing flat surfaces that are at right angles to the axis of rotation of the cutter. Generally, the cutters cut a limited depth on the circumferential surface of the tool.

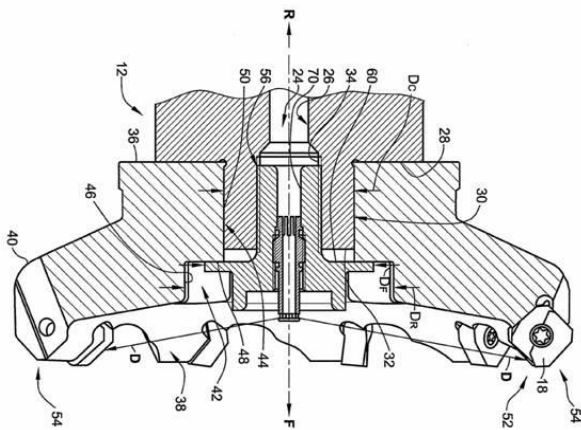

B23C 5/08

Definition statement

This place covers:

Cutters having a cutter body with the general configuration of a disc, i.e. a thin, flat, round shape, for cutting grooves or slots into the workpiece. Also known as side cutter or side-and-face cutter.

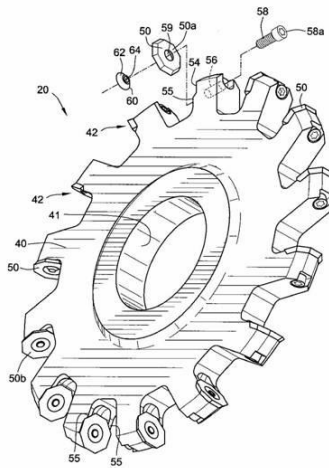

Relationships with other classification places

When the cutter divides or cuts a metal workpiece into two pieces, the cutter is considered a sawing tool and should be classified in B23D 45/00.

Special rules of classification

Milling cutters used in whirling processes should receive a classification in B23C2220/68.

CPC NOTICE OF CHANGES 1261

DATE: FEBRUARY 1, 2022

PROJECT RP0552

Plate-like cutting inserts fitted on a ring or ring segment attached to a separate, main tool body should be classified in the following: B23C 5/2234, B23C 5/226, B23C 5/2291 or B23C 5/2309.

B23C 5/10

Definition statement

This place covers:

An end mill (also called a slot drill) having a generally cylindrical shank with a cutting portion extending from the shank. The cutting portion is capable of cutting in the axial and radial directions by cutting edges on the circumferential and end surfaces of the cutting portion.

Milling cutter (slot drill) with shank having end cutters extending to cutter axis to enable axial feed:

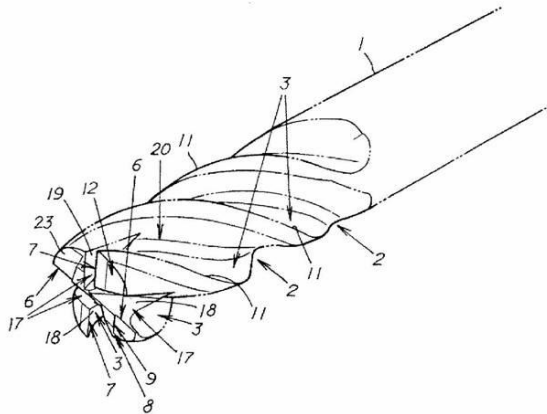

Milling cutter with head detachable from shaft:

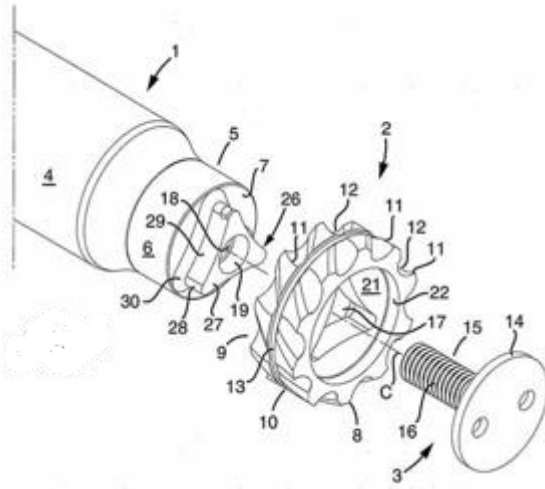

Milling cutter with shaft for roughing:

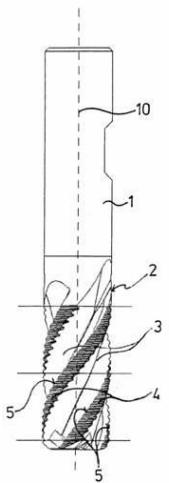

Relationships with other classification places

Note that milling cutters with shafts that include inventive features related to the securing or placement in the chuck are classified in B23B31/005 or B23B31/006, accompanied by Indexing Codes from B23B2231/02 and subgroups.

Special rules of classification

DATE: FEBRUARY 1, 2022

PROJECT RP0552

Note that milling cutters with detachable heads are placed here with the allocation of Indexing codes B23C2210/02 and/or B23C2210/03 as appropriate. A detachable head is generally seen as being something attached to the end of the shank that covers the whole of the cross section of the shank.

B23C 5/1036

Definition statement

This place covers:

Ball nosed milling cutter with removable insert.

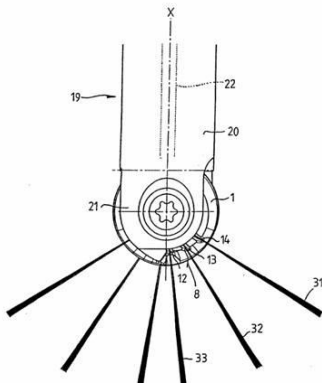

B23C 5/1054

Definition statement

This place covers:

A slot cutter that produces a finished slot in the shape of the letter "T" (also includes inverted letter "T").

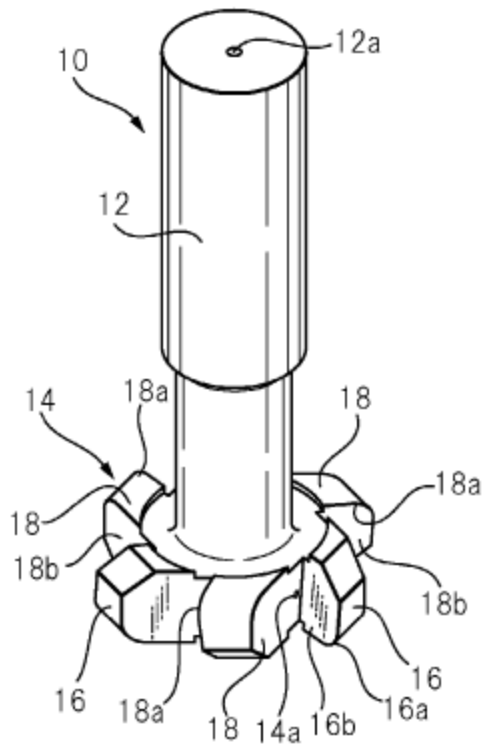

B23C 5/1081

Definition statement

This place covers:

Milling cutter with shaft and permanently attached inserts, e.g. via welding or brazing:

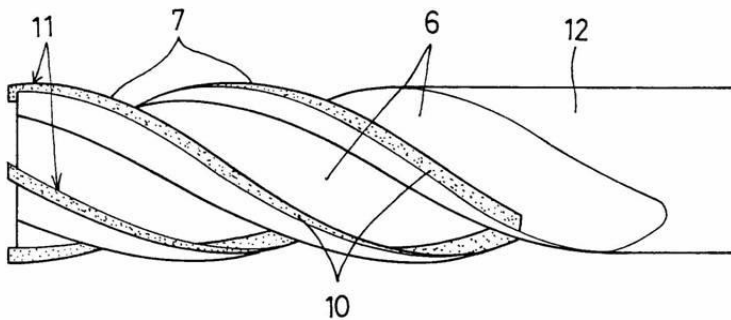

References

Limiting references

This place does not cover:

Ball nose end mills with permanently fixed cutting inserts	B23C5/1018
T slot cutters with permanently fixed cutting inserts	B23C5/1063

Special rules of classification

Note that milling cutters with permanently attached inserts made of PCD or CBN are placed here with the allocation of Indexing codes B23C2226/315 for PCD or B23C2226/125 for CBN.

B23C 5/109

Definition statement

This place covers:

Milling cutter with shaft and removable inserts.

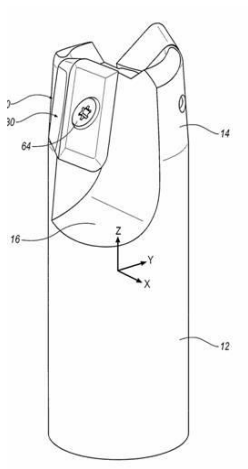

Special rules of classification

Note that milling cutters with detachable heads are not classed in B23C5/109 but in B23C5/10 with the allocation of Indexing Codes B23C2210/02 and/or B23C2210/03 as appropriate. A detachable head is generally seen as being something attached to the end of the shank that covers the whole of the cross section of the shank.

DATE: FEBRUARY 1, 2022

PROJECT RP0552

B23C 5/12

Definition statement

This place covers:

Cutters for producing a particular profile, i.e. cutting edge shape has a direct correlation to the finished shape of the workpiece.

References

Limiting references

This place does not cover:

Shank-type cutters, i.e. with an integral shaft	B23C5/10
---	----------

Special rules of classification

Indexing Codes for chamfering (B23C2220/16) and turbine blade grooves (B23C2220/366) should be considered if those profiles are present.

B23C 5/18

Definition statement

This place covers:

Milling cutter with permanently fixed inserts.

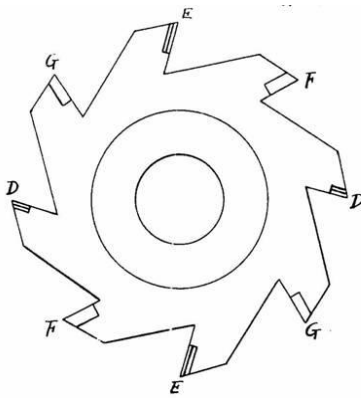

References

Informative references

Attention is drawn to the following places, which may be of interest for search:

Shank-type cutters with permanently fixed cutting inserts	B23C 5/1081
---	-----------------------------

DATE: FEBRUARY 1, 2022

PROJECT RP0552

B23C 5/20

Definition statement

This place covers:

Removable cutting inserts that are generic, i.e. no special shape or special features.

Special rules of classification

Documents classified in B23C5/20, B23C5/22 and B23C5/24 should also receive Indexing Codes from group B23C2200/00 entitled "Details of milling inserts" when applicable. Indexing Codes should be allocated only for special features of the insert.

For example, if the insert has a fixation hole of a special shape, the appropriate Indexing Code (B23C2200/361) should be given. This Indexing Code should not, however, be given to every insert having a fixation hole.

An Indexing Code from the group B23C2200/00 entitled "Details of cutting inserts" takes precedence over an Indexing Code from other groups.

For example, an insert with a curved cutting edge should be allocated the Indexing Code B23C2200/203. The allocation of B23C2210/084 is not necessary or desired.

B23C 5/202

Definition statement

This place covers:

Removable cutting inserts having a special shape. The shape may be considered special by virtue of, inter alia, the overall shape and cutting edge configuration.

Examples:

Tangentially mounted milling insert:

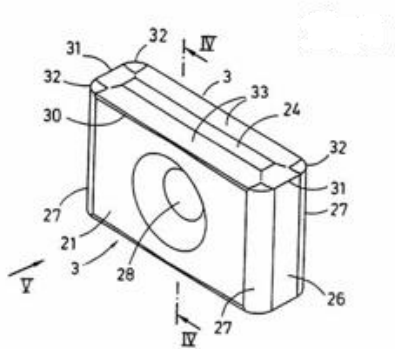

Milling insert with curved cutting edge and wiper:

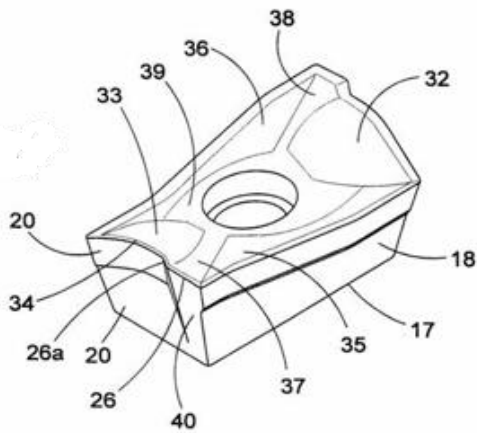

Milling insert with interrupted cutting edge and chip-breaking projections on the top surface:

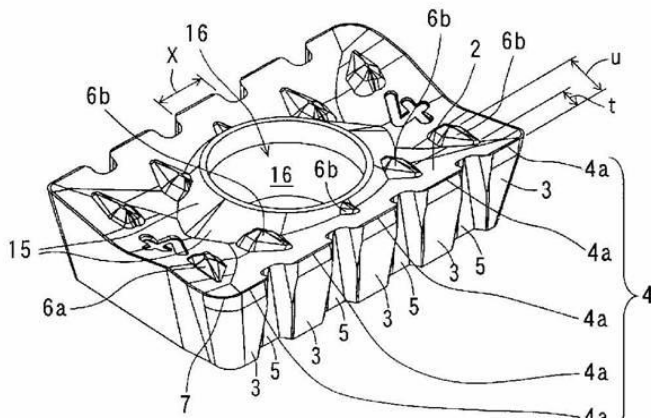

Milling insert with sloped cutting edges (6a-d) and rake faces (10) above a central surface (9):

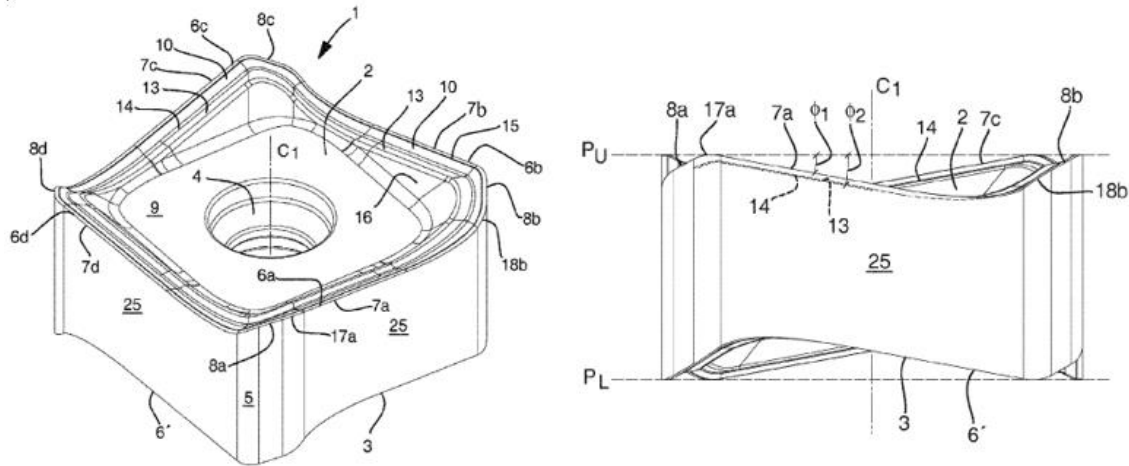

Relationships with other classification places

B23B27/141, B23B27/143 and B23B27/145 are the equivalent subgroups for turning or general-purpose inserts. If the insert can be used for turning and milling only a class in B23B27/141, B23B27/143 or B23B27/145 is given.

Inserts in this subgroup are not classed for composition of inserts (C22C or C04B) or merely for the composition of the coating (see C23C). However inserts where the coating is selectively applied to areas of the insert or having a particular material and a special shape will be classed here.

References

Limiting references

This place does not cover:

Cutting insert having special form related to the securing arrangement within the holder	B23C5/22
--	----------

Special rules of classification

Note that end mills with detachable heads are not classified as end mills with cutting inserts in B23C5/202, but in B23C5/10 with the Indexing Codes B23C2210/02 or B23C2210/03 as appropriate.

CPC NOTICE OF CHANGES 1261

DATE: FEBRUARY 1, 2022

PROJECT RP0552

Inserts having a special shape by virtue only of the chip-breakers are classed in B23C5/205.

Cutting inserts having a special shape related to securing the cutting inserts, e.g. locating or clamping the insert within the holder, should be classified in B23C5/22 or subgroups B23C5/2204, B23C5/2208, B23C5/2239, B23C5/2243, B23C5/2265, B23C5/2269, B23C5/2295, B23C5/2298 or B23C5/2301 according to the clamping mechanism.

Cutting inserts having a special shape that is not related to securing or locating the cutting insert within the tool body and a special shape that is related to securing or locating the cutting insert within the tool body should be classified in B23C 5/202 (or subgroup B23C 5/205) and B23C 5/22 (or subgroups).

B23C 5/205

Definition statement

This place covers:

Inserts having a special shape by virtue only of the chip-breakers.

Examples:

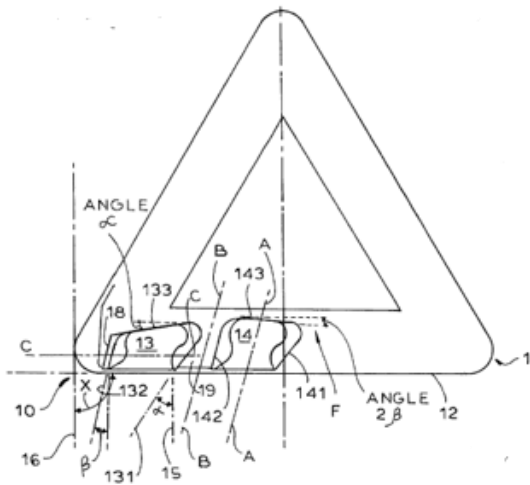
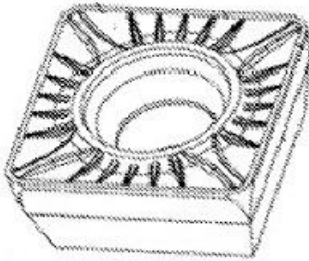

DATE: FEBRUARY 1, 2022

PROJECT RP0552

B23C 5/22

Definition statement

This place covers:

Special arrangements of how the cutting inserts are fastened to the cutter body.

Special rules of classification

Cutting inserts having a special shape that is not related to securing or locating the cutting insert within the tool body and a special shape that is related to securing or locating the cutting insert within the tool body should be classified in B23C5/202 (or subgroup B23C5/205) and one of the following subgroups according to the clamping mechanism: B23C5/2213, B23C5/2247, B23C5/2273 or B23C5/2304.

Documents classified in B23C5/20, B23C5/22 and B23C5/24 should also receive Indexing Codes from group B23C2200/00 entitled "Details of milling inserts" when applicable. Indexing Codes should be allocated only for special features of the insert. For example, if the insert has a fixation hole of a special shape, the appropriate Indexing Code (B23C2200/361) should be given. This Indexing Code should not, however, be given to every insert having a fixation hole.

An Indexing Code from the group B23C2200/00 entitled "Details of cutting inserts" takes precedence over an Indexing Code from other groups. For example, an insert with a curved cutting edge should be allocated the Indexing Code B23C2200/203. The allocation of B23C2210/084 is not necessary or desired.

B23C 5/2208

Definition statement

This place covers:

Plate-like cutting inserts clamped against walls of the recess in the shank by a clamping member acting upon the wall of a hole in the insert.

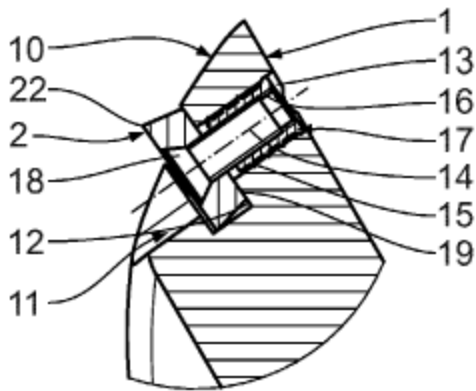

References

Limiting references

This place does not cover:

For plate-like cutting inserts fitted on an intermediate carrier, e.g. shank fixed in the cutter body	B23C5/2226
For plate-like cutting inserts fitted on a ring or ring segment	B23C5/2234

B23C 5/2213

Definition statement

This place covers:

Plate-like cutting inserts of special shape where clamping against the walls of a pocket by means of something acting on the hole in the insert is also important. The shape may be considered special by virtue of, inter alia, the overall shape and cutting edge configuration.

Example:

Insert has a special shape due to the fixation hole being widened at the bottom to permit the inclined orientation of the fastener and the fastener interacts with the sidewall of the hole in the insert.

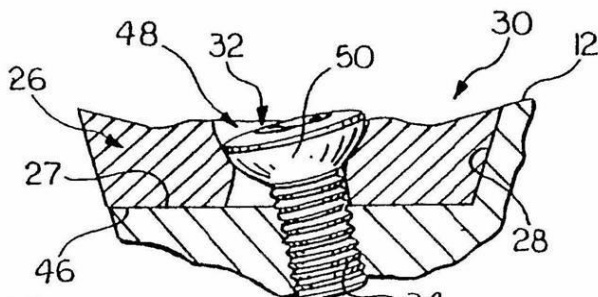

B23C 5/2226

Definition statement

This place covers:

Plate-like cutting insert clamped against walls of the recess in an intermediate carrier of the cutter body by a clamping member acting upon the wall of a hole in the insert.

Example:

Intermediate carrier (10) with insert (11)

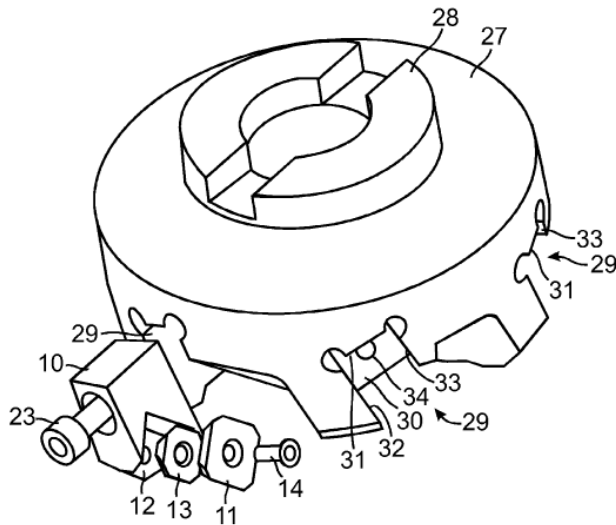

Example:

Intermediate carrier (A) formed as a shank for insert (B)

CPC NOTICE OF CHANGES 1261

DATE: FEBRUARY 1, 2022

PROJECT RP0552

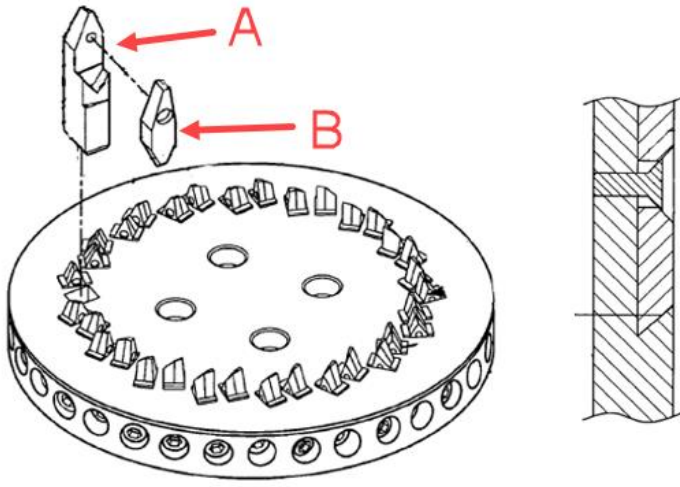

B23C 5/2234

Definition statement

This place covers:

Plate-like cutting inserts clamped against walls of the recess in a shank (16) by a clamping member (14) acting upon the wall of a hole in the insert, and fitted on a ring (10):

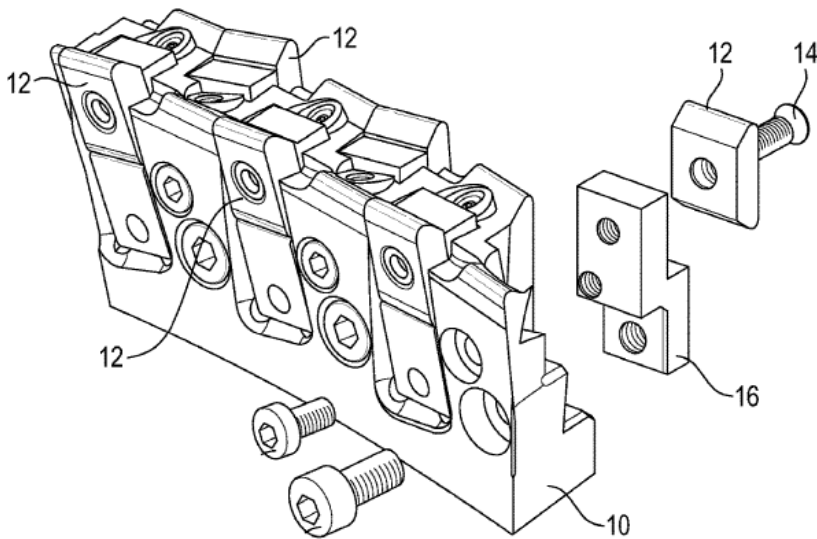

B23C 5/2239

Definition statement

This place covers:

Plate-like cutting inserts clamped by clamping member (32) acting almost perpendicular on the cutting face:

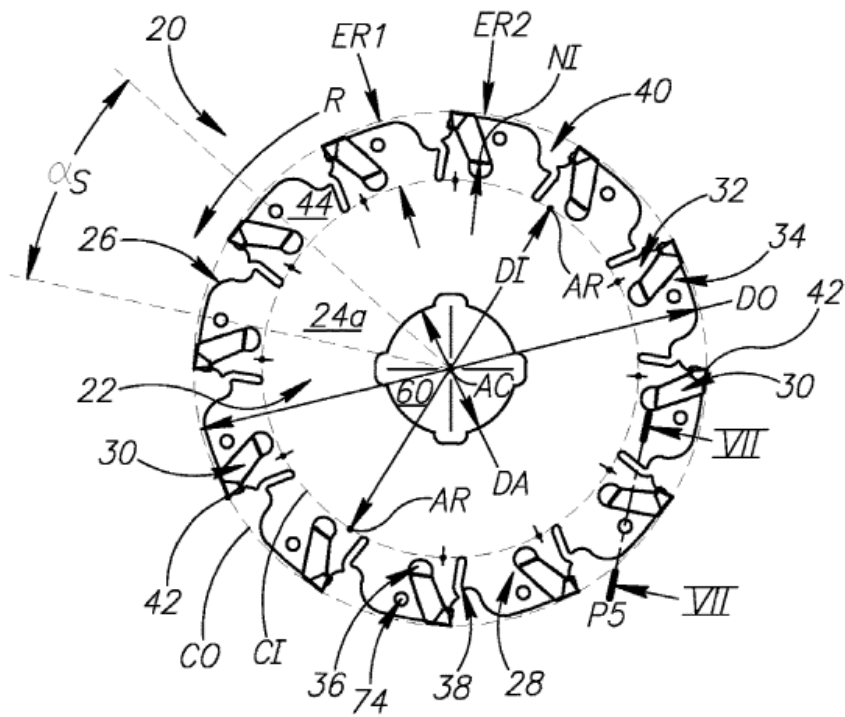

B23C 5/2243

Definition statement

This place covers:

Plate-like cutting inserts (3) clamped by a clamping member (4) acting almost perpendicular on the cutting face:

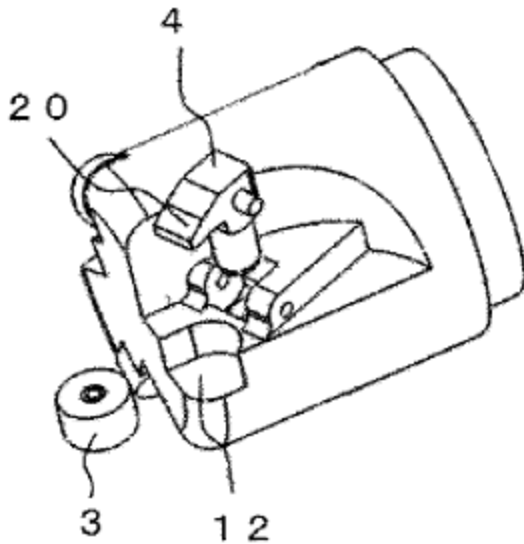

References

Limiting references

This place does not cover:

For plate-like cutting inserts fitted on an intermediate carrier, e.g. shank fixed in the cutter body	B23C5/2252
For plate-like cutting inserts fitted on a ring or ring segment	B23C5/226

B23C 5/2247

Definition statement

This place covers:

Plate-like cutting inserts of special shape clamped by member acting on top surface. The shape may be considered special by virtue of, inter alia, the overall shape and cutting edge configuration.

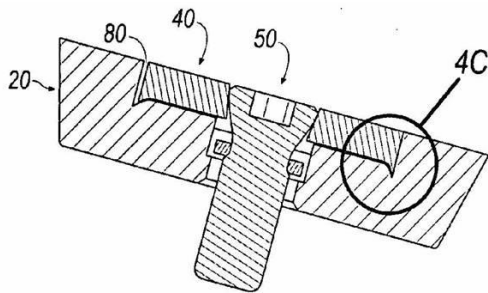
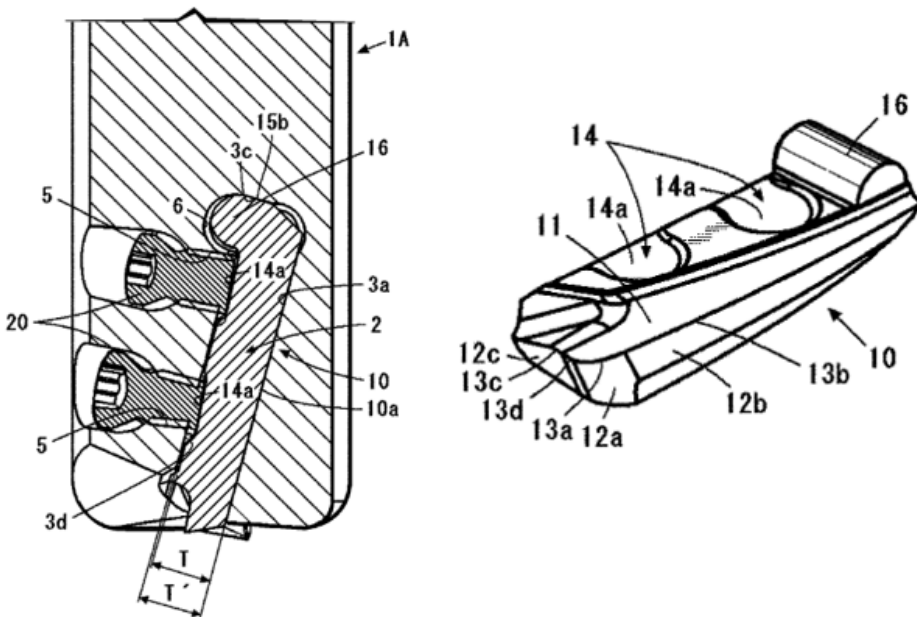

Plate-like cutting insert (10) having a special shape and clamped by clamping member (20) acting almost perpendicular (14) on the cutting face:



B23C 5/2252

Definition statement

This place covers:

Plate-like cutting inserts (30) clamped by a clamping member (40) acting almost perpendicular on the cutting face, and fitted on an intermediate carrier (20):

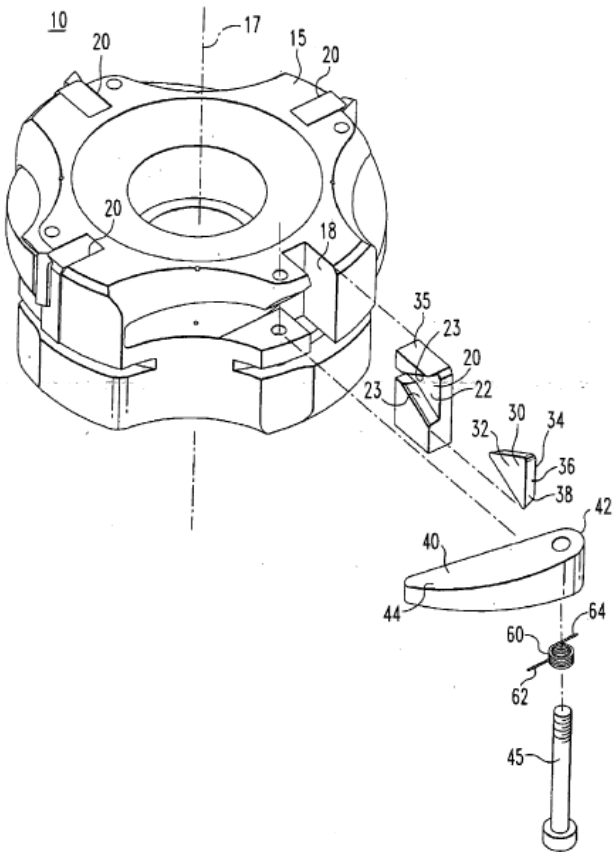

B23C 5/2269

Definition statement

This place covers:

Generic, i.e. no special shape or special features, plate-like milling inserts clamped by a wedge.

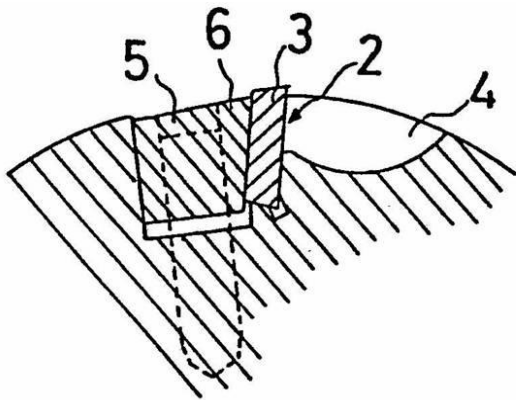

References

Limiting references

This place does not cover:

For plate-like cutting inserts fitted on an intermediate carrier, e.g. shank fixed in the cutter body	B23C5/2278
For plate-like cutting inserts fitted on a ring or ring segment	B23C5/2291

B23C 5/2291

Definition statement

This place covers:

Example:

Plate-like cutting insert (27) fitted on a ring segment (45) and secured by a wedge (77).

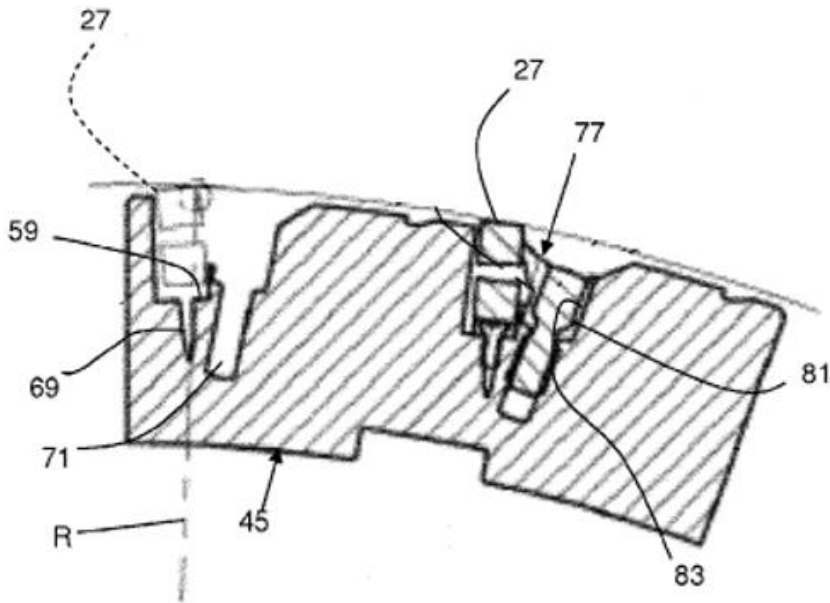

B23C 5/2295

Definition statement

This place covers:

Simultaneous clamping of all cutting inserts.

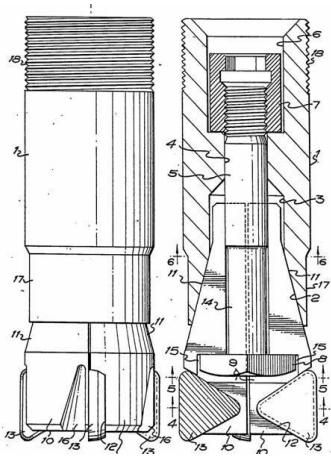

B23C 5/2309

Definition statement

This place covers:

Example:

Plate-like cutting insert (5, 51) fitted on a ring segment (13) and secured by resilient/flexible means (3, 4).

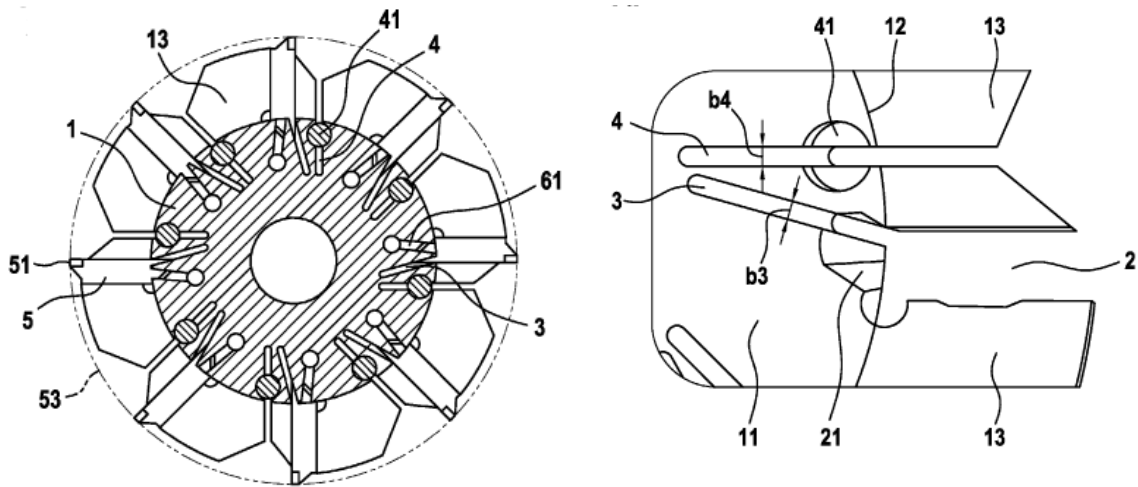

DATE: FEBRUARY 1, 2022

PROJECT RP0552

B23C 5/24

Definition statement

This place covers:

Features relative to the adjustment of the insert relative to the cutter body.

Special rules of classification

Documents classified in B23C5/20, B23C5/22 and B23C5/24 should also receive Indexing Codes from group B23C2200/00 entitled "Details of milling inserts" when applicable. Indexing Codes should be allocated only for special features of the insert.

For example, if the insert has a fixation hole of a special shape, the appropriate Indexing Code (B23C2200/361) should be given. This Indexing Code should not, however, be given to every insert having a fixation hole.

An Indexing Code from the group B23C2200/00 entitled "Details of cutting inserts" takes precedence over an Indexing Code from other groups.

For example, an insert with a curved cutting edge should be allocated the Indexing Code B23C2200/203. The allocation of B23C2210/084 is not necessary or desired.

B23C 5/2462

Definition statement

This place covers:

Adjustment of insert position by oblique surfaces.

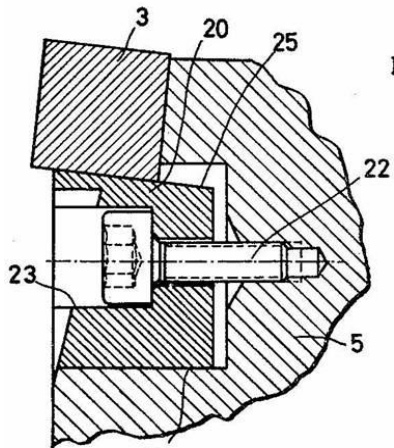

B23C 5/2465

Definition statement

This place covers:

Adjustment of position of insert by notches.

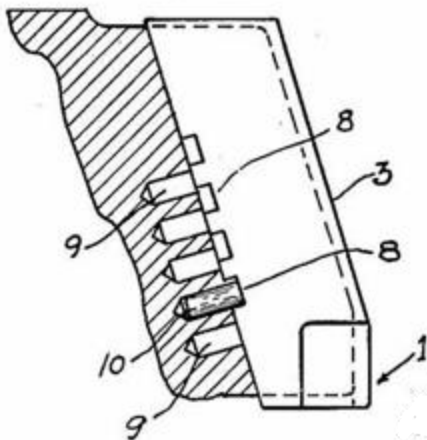

B23C 5/2468

Definition statement

This place covers:

Adjustment of insert position by means of serrations.

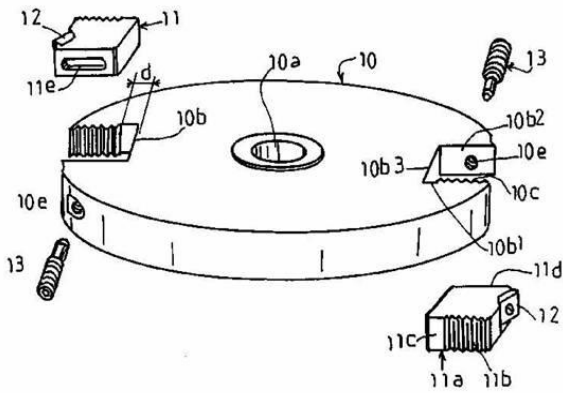

B23C 5/2472

Definition statement

This place covers:

Adjustment of insert position by means of screws.

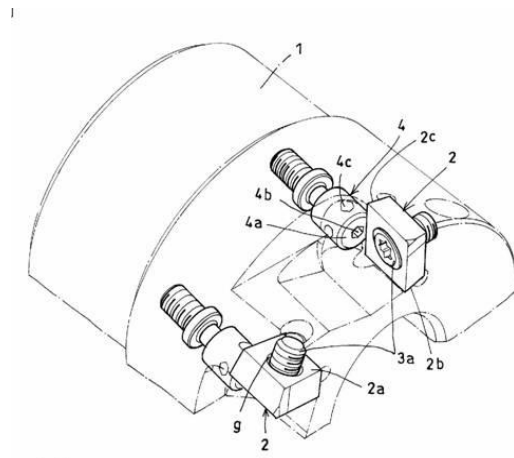

B23C 5/2475

Definition statement

This place covers:

Adjustment of insert position by means of spacers.

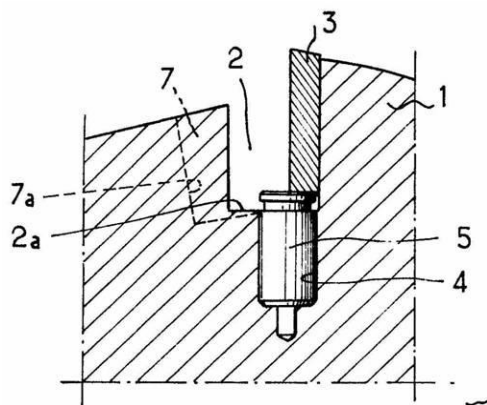

B23C 5/2479

Definition statement

This place covers:

Adjustment of insert position by means of rotating an eccentric, i.e. an object that is not perfectly circular.

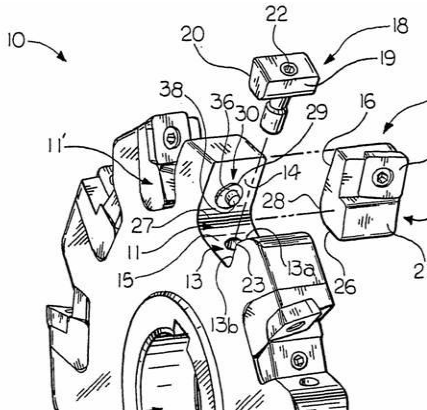

B23C 5/2486

Definition statement

This place covers:

Adjustment by means of elastically deforming the tool carrier.

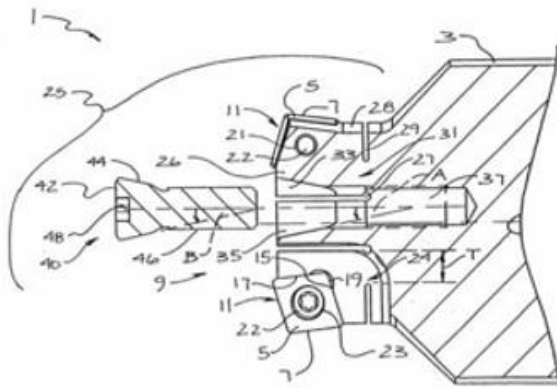

B23C 5/26

Definition statement

This place covers:

Details of arrangements for securing cutters to the spindle, including details of intermediate connecting members, e.g. arbors.

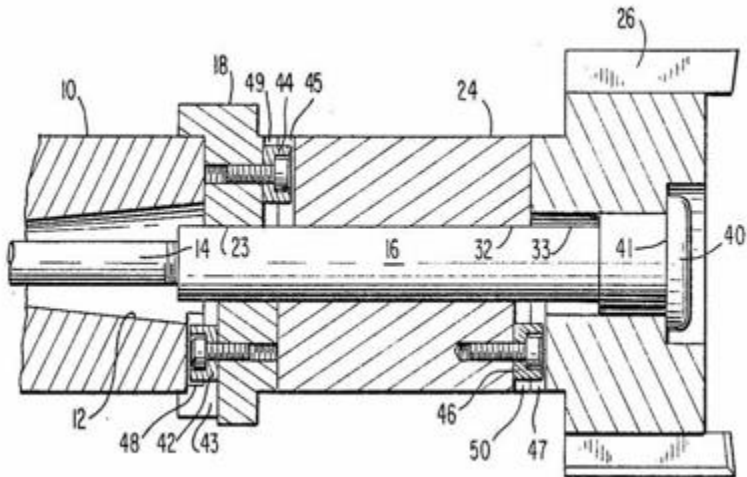

References

Informative references

Attention is drawn to the following places, which may be of interest for search:

Chucks	B23B 31/00
--------	----------------------------

DATE: FEBRUARY 1, 2022

PROJECT RP0552

B23C 5/28

Definition statement

This place covers:

Features concerning cooling arrangements within or on the cutter body. This area does not include cooling features of the machine in general.

Relationships with other classification places

See also B23B27/10, B23B51/06 and B23D77/006 for equivalents in turning, drilling & reaming respectively.

References

Informative references

Attention is drawn to the following places, which may be of interest for search:

Arrangements for cooling or lubricating tools or work, in general	B23Q11/10
---	-----------

Special rules of classification

Note also the Indexing Code relating to cooling (B23C2250/12) for non-invention information.

B23C 5/281

Definition statement

This place covers:

Milling cutters with means for coolant to move along the outside of the tool periphery toward cutting edges. This area is not meant for coolant outlets that exit from an interior channel into the chip flutes that then guide the coolant toward the cutting edges.

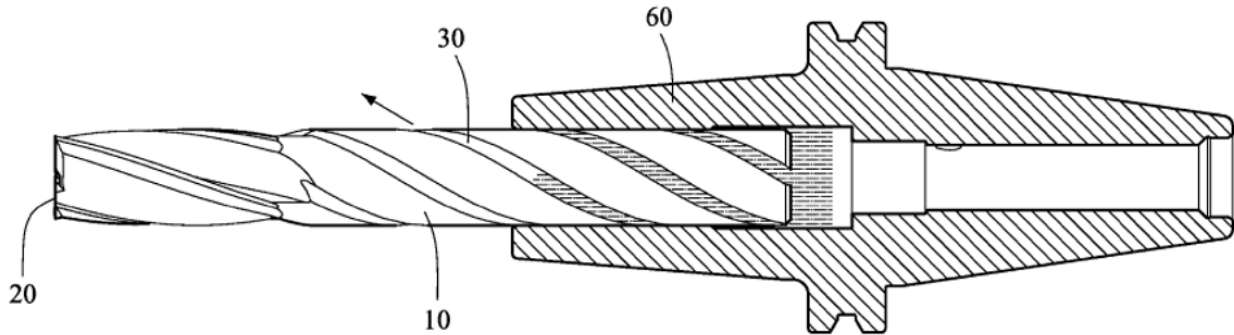

B23C 5/282

Definition statement

This place covers:

Special details of the coolant channel(s) cross-sectional shape (cross-section not required to be perpendicular to rotation axis of cutter body). The term "special" means non-generic details of the cross-sectional shape, e.g. mere cross-sections of a single circular nature would be excluded from this sub-class.

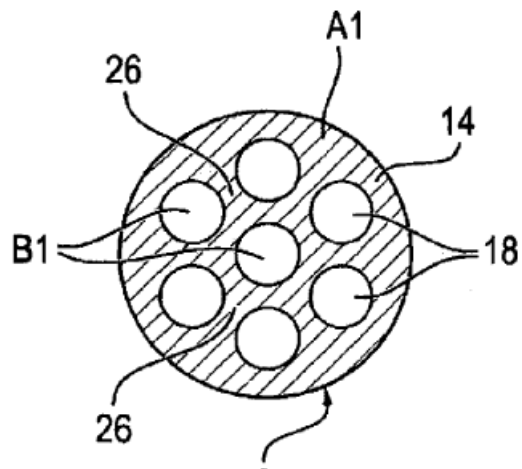
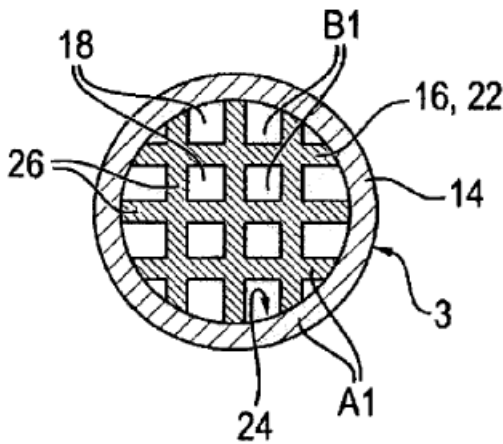

B23C 5/283

Definition statement

This place covers:

Cutting inserts with interior coolant channels.

Example:

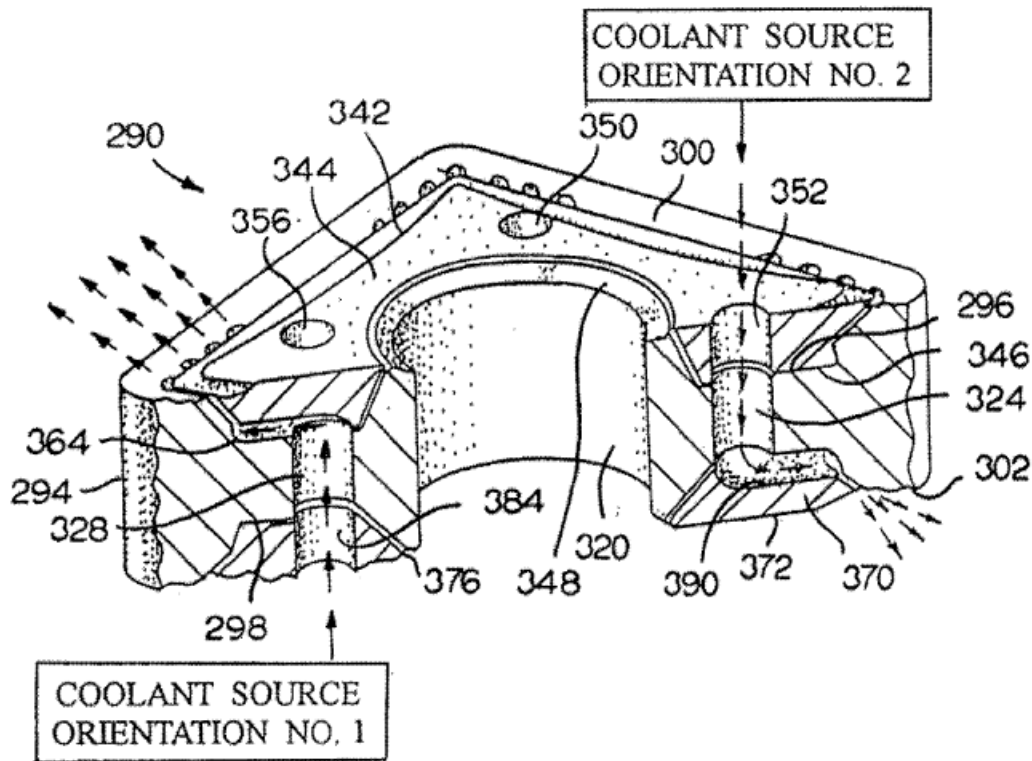

Example:

DATE: FEBRUARY 1, 2022

PROJECT RP0552

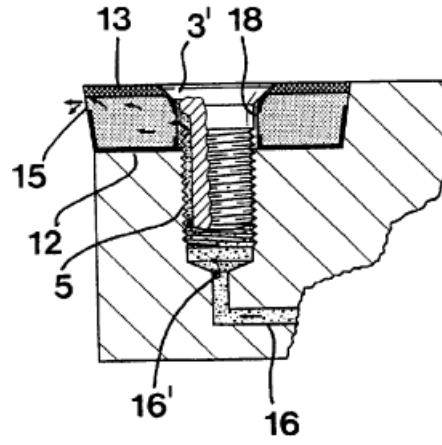
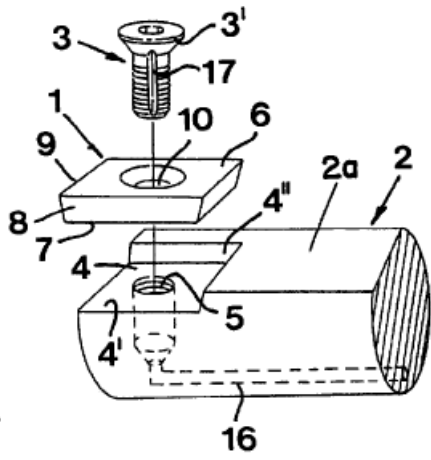

B23C 5/285

Definition statement

This place covers:

Nozzles to point or direct the coolant in a desired direction.

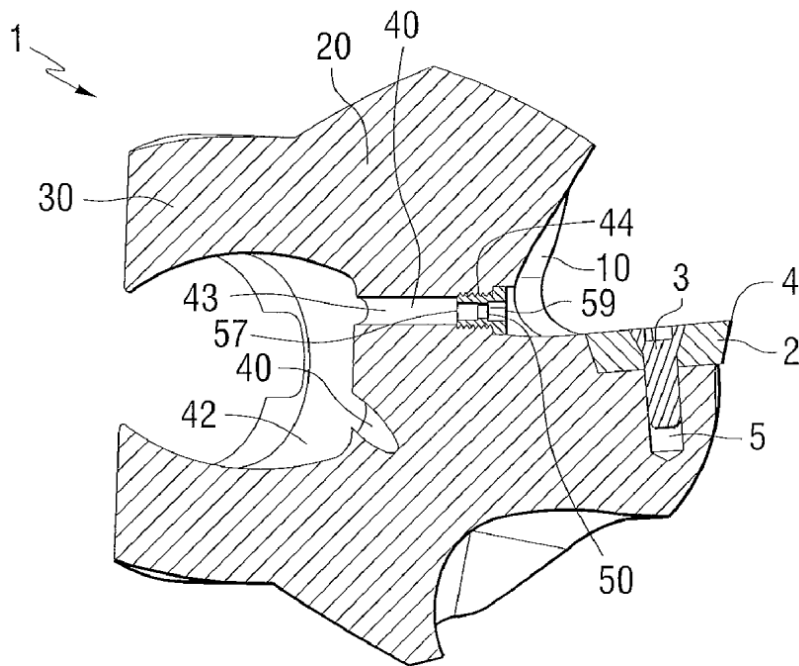

B23C 5/286

Definition statement

This place covers:

Deflector to point or direct the coolant in a desired direction.

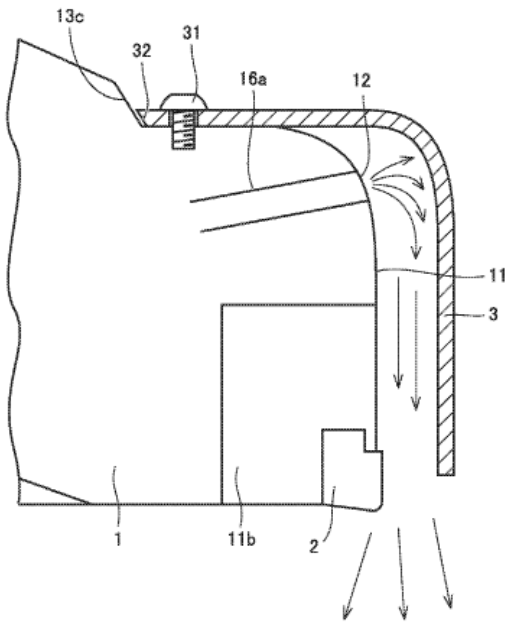

B23C 5/287

Definition statement

This place covers:

Deflector intersects the rotational axis of the cutter body such that coolant is deflected at the rotational axis.

Example:

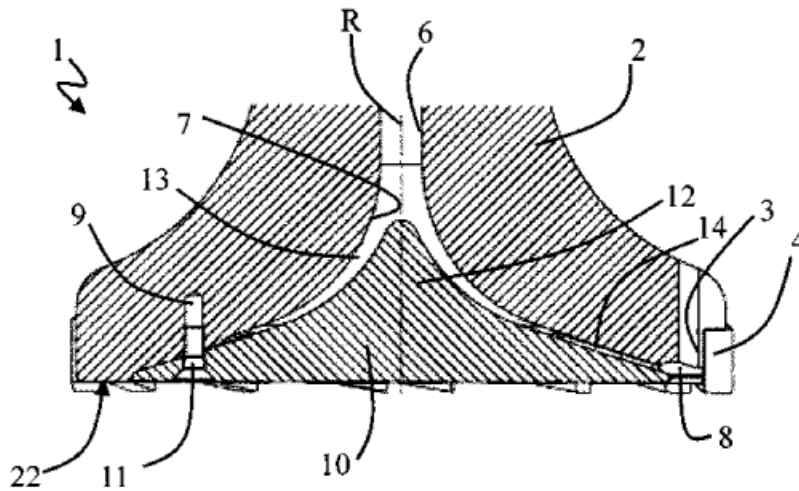

Example:

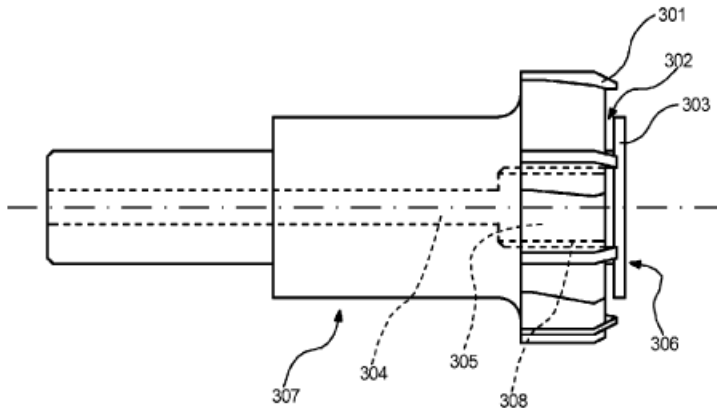

DATE: FEBRUARY 1, 2022

PROJECT RP0552

2. B. DEFINITIONS (modified)

B23C5/00

Delete: The entire Definition statement, including ALL images.

Special rules of classification

Replace: The existing Special rules of classification with the updated text below.

Classification is generally per literal interpretation of the group and subgroup headings.

Allocation of Indexing Codes from the section "Details of milling cutters" [B23C 2210/00](#) is mandatory in [B23C 5/00](#).

CPC NOTICE OF CHANGES 1261

DATE: FEBRUARY 1, 2022

PROJECT RP0552

3. REVISION CONCORDANCE LIST (RCL)

<u>Type*</u>	<u>From CPC Symbol (existing)</u>	<u>To CPC Symbol(s)</u>
C	B23C 5/202	B23C 5/202, B23C 5/205
D	B23C 5/207	<Administrative transfer to B23C 5/202>
C	B23C 5/22	B23C 5/22, B23C 5/2298, B23C 5/2301, B23C 5/2304, B23C 5/2306, B23C 5/2309
C	B23C 5/2204	B23C 5/2204, B23C 5/2298
C	B23C 5/2208	B23C 5/2208, B23C 5/2301
C	B23C 5/2213	B23C 5/2213, B23C 5/2304
D	B23C 5/2217	<Administrative transfer to B23C 5/205>
D	B23C 5/2221	<Administrative transfer to B23C 5/2213>
C	B23C 5/2226	B23C 5/2226, B23C 5/2306
D	B23C 5/223	<Administrative transfer to B23C 5/2226>
C	B23C 5/2234	B23C 5/2234, B23C 5/2309
C	B23C 5/2239	B23C 5/2239, B23C 5/2298
C	B23C 5/2243	B23C 5/2243, B23C 5/2301
C	B23C 5/2247	B23C 5/2247, B23C 5/2304
C	B23C 5/2252	B23C 5/2252, B23C 5/2306
D	B23C 5/2256	<Administrative transfer to B23C 5/2252>
C	B23C 5/226	B23C 5/226, B23C 5/2309
C	B23C 5/2265	B23C 5/2265, B23C 5/2298
C	B23C 5/2269	B23C 5/2269, B23C 5/2301
C	B23C 5/2273	B23C 5/2273, B23C 5/2304
C	B23C 5/2278	B23C 5/2278, B23C 5/2306
D	B23C 5/2282	<Administrative transfer to B23C 5/2278>
D	B23C 5/2286	<Administrative transfer to B23C 5/2278>
C	B23C 5/2291	B23C 5/2291, B23C 5/2309
C	B23C 5/2295	B23C 5/2295, B23C 5/2298
C	B23C 5/24	B23C 5/24, B23C 5/2462, B23C 5/2465, B23C 5/2468, B23C 5/2472, B23C 5/2475, B23C 5/2479, B23C 5/2482, B23C 5/2486, B23C 5/2489, B23C 5/2493, B23C 5/2496
D	B23C 5/2403	<Administrative transfer to B23C 5/24 and B23C 5/2204 simultaneously>
D	B23C 5/2406	<Administrative transfer to B23C 5/24 and B23C 5/2208 simultaneously>
D	B23C 5/241	<Administrative transfer to B23C 5/24 and B23C 5/2226 simultaneously>
D	B23C 5/2413	<Administrative transfer to B23C 5/24 and B23C 5/2226 simultaneously>
D	B23C 5/2417	<Administrative transfer to B23C 5/24 and B23C 5/2234 simultaneously>
D	B23C 5/242	<Administrative transfer to B23C 5/24 and B23C 5/2239 simultaneously>
D	B23C 5/2424	<Administrative transfer to B23C 5/24 and B23C 5/2243 simultaneously>
D	B23C 5/2427	<Administrative transfer to B23C 5/24 and B23C 5/2252 simultaneously>
D	B23C 5/2431	<Administrative transfer to B23C 5/24 and B23C 5/2252 simultaneously>

CPC NOTICE OF CHANGES 1261

DATE: FEBRUARY 1, 2022

PROJECT RP0552

Type*	From CPC Symbol (existing)	To CPC Symbol(s)
D	B23C 5/2434	<Administrative transfer to B23C 5/24 and B23C 5/226 simultaneously>
D	B23C 5/2437	<Administrative transfer to B23C 5/24 and B23C 5/2265 simultaneously>
D	B23C 5/2441	<Administrative transfer to B23C 5/24 and B23C 5/2269 simultaneously>
D	B23C 5/2444	<Administrative transfer to B23C 5/24 and B23C 5/2278 simultaneously>
D	B23C 5/2448	<Administrative transfer to B23C 5/24 and B23C 5/2278 simultaneously>
D	B23C 5/2451	<Administrative transfer to B23C 5/24 and B23C 5/2291 simultaneously>
D	B23C 5/2455	<Administrative transfer to B23C 5/24 and B23C 5/2265 simultaneously>
D	B23C 5/2458	<Administrative transfer to B23C 5/24 and B23C 5/2295 simultaneously>
C	B23C 5/28	B23C 5/28, B23C 5/281, B23C 5/282, B23C 5/283, B23C 5/285, B23C 5/286, B23C 5/287
D	B23C 2200/087	<Administrative transfer to B23C 2200/326>
C	B23C 2200/28	B23C 2200/28, B23C 2200/291, B23C 2200/293
F	B23C 2200/283	B23C 2200/281, B23C 2200/284
F	B23C 2200/286	B23C 2200/287, B23C 2200/289
C	B23C 2200/36	B23C 2200/36, B23C 2200/364, B23C 2200/369, B23C 2200/3691
C	B23C 2210/50	B23C 2210/50, B23C 2210/501, B23C 2210/502, B23C 2210/504
C	B23C 2210/64	B23C 2210/64, B23C 2210/641

* C = entries with modified file scope where reclassification of documents from the entries is involved; Q = new entries which are firstly populated with documents via administrative transfers from deleted (D) entries. Afterwards, the transferred documents into the Q entry will either stay or be moved to more appropriate entries, as determined by intellectual reclassification; D = deleted entries; F = frozen entries will be deleted once reclassification of documents from the entries is completed.

NOTES:

- **Only** C, D, F, and Q type entries are included in the table above.
- When multiple symbols are included in the “To” column, do not use ranges of symbols.
- For administrative transfer of documents, the following text should be used: “< administrative transfer to XX>”, “<administrative transfer to XX and YY simultaneously>”, or “<administrative transfer to XX, YY, ...and ZZ simultaneously>” when administrative transfer of the same documents is to more than one place.
- Administrative transfer to main trunk groups is assumed to be the source allocation type, unless otherwise indicated.
- Administrative transfer to 2000/Y series groups is assumed to be “additional information”.
- If needed, instructions for allocation type should be indicated within the angle brackets using the abbreviations “ADD” or “INV”: <administrative transfer to XX ADD>, <administrative transfer to XX INV>, or < administrative transfer to XX ADD, YY INV, ... and ZZ ADD simultaneously>.
- In certain situations, the “D” entries of 2000-series or Y-series groups may not require a destination (“To”) symbol, however it is required to specify “<no transfer>” in the “To” column for such cases.
- RCL is not needed for finalisation projects.

CPC NOTICE OF CHANGES 1261

DATE: FEBRUARY 1, 2022

PROJECT RP0552

4. CHANGES TO THE CPC-TO-IPC CONCORDANCE LIST (CICL)

<u>CPC</u>	<u>IPC</u>	<u>Action*</u>
B23C 5/207		DELETE
B23C 5/2217		DELETE
B23C 5/2221		DELETE
B23C 5/223		DELETE
B23C 5/2256		DELETE
B23C 5/2282		DELETE
B23C 5/2286		DELETE
B23C 5/2298	B23C 5/22	NEW
B23C 5/2301	B23C 5/22	NEW
B23C 5/2304	B23C 5/22	NEW
B23C 5/2306	B23C 5/22	NEW
B23C 5/2309	B23C 5/22	NEW
B23C 5/2403		DELETE
B23C 5/2406		DELETE
B23C 5/241		DELETE
B23C 5/2413		DELETE
B23C 5/2417		DELETE
B23C 5/242		DELETE
B23C 5/2424		DELETE
B23C 5/2427		DELETE
B23C 5/2431		DELETE
B23C 5/2434		DELETE
B23C 5/2437		DELETE
B23C 5/2441		DELETE
B23C 5/2444		DELETE
B23C 5/2448		DELETE
B23C 5/2451		DELETE
B23C 5/2455		DELETE
B23C 5/2458		DELETE
B23C 5/281	B23C 5/28	NEW
B23C 5/282	B23C 5/28	NEW
B23C 5/283	B23C 5/28	NEW
B23C 5/285	B23C 5/28	NEW
B23C 5/286	B23C 5/28	NEW
B23C 5/287	B23C 5/28	NEW
B23C 2200/087		DELETE
B23C 2200/281	CPCONLY	NEW
B23C 2200/284	CPCONLY	NEW
B23C 2200/287	CPCONLY	NEW

CPC NOTICE OF CHANGES 1261

DATE: FEBRUARY 1, 2022

PROJECT RP0552

<u>CPC</u>	<u>IPC</u>	<u>Action*</u>
B23C 2200/289	CPCONLY	NEW
B23C 2200/291	CPCONLY	NEW
B23C 2200/293	CPCONLY	NEW
B23C 2200/364	CPCONLY	NEW
B23C 2200/369	CPCONLY	NEW
B23C 2200/3691	CPCONLY	NEW
B23C 2210/501	CPCONLY	NEW
B23C 2210/502	CPCONLY	NEW
B23C 2210/504	CPCONLY	NEW
B23C 2210/641	CPCONLY	NEW

*Action column:

- For an (N) or (Q) entry, provide an IPC symbol and complete the Action column with “NEW.”
- For an existing CPC main trunk entry or indexing entry where the existing IPC symbol needs to be changed, provide an updated IPC symbol and complete the Action column with “UPDATED.”
- For a (D) CPC entry or indexing entry complete the Action column with “DELETE.” IPC symbol does not need to be included in the IPC column.
- For an (N) 2000 series CPC entry which is positioned within the main trunk scheme (breakdown code) provide an IPC symbol and complete the action column with “NEW”.
- For an (N) 2000 series CPC entry positioned at the end of the CPC scheme (orthogonal code), with no IPC equivalent, complete the IPC column with “CPCONLY” and complete the action column with “NEW”.

NOTES:

- F symbols are not included in the CACL table above.
- T and M symbols are not included in the CACL table above unless a change to the existing IPC is desired.